

Single Row Tapered Roller Bearing

33000 Series-31330XJ2

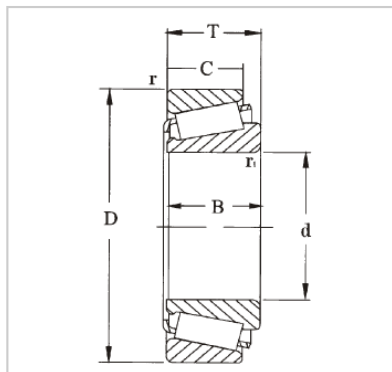

WUXI GUANGQIANG BEARING TRADE CO.,LTD

Designação	31330XJ2
Dimensões principais (mm)	
d1	150
D	320
B	82
Classificações básicas de carga (KN)	
dyc (Cr)	781
stc (Cor)	1020
Pu	100
Avaliações de velocidade (rpm)	
Classificações de velocidade	1400
Limitando a velocidade	2000
Peso (Kg)	29.5
ISO335	
Dimensões (ABMA)	7GB
Dimensões [mm]	
d	150
d1	234
B	75
C	50
r1,2 (min)	5
r3,4 (min)	4
uma	96
Dimensões de abutment e filete [mm]	
da (max)	181
db (min)	170
Da (min)	251
Da (max)	303
Db (min)	300
Ca (min)	9
Cb (min)	32
ra (max)	4
rb (max)	3
Valor	
e	0.83
Y	0.72
Yo	0.4

GQZ high quality 33000 Series Single Row Tapered Roller Bearing

Tapered roller bearings have tapered inner and outer raceways and rollers to handle simultaneous radial and thrust loads. Their axial load carrying capacity is directly related to the contact angle of the rollers and raceway shaft.

They are available in single-row, double-row, and four-row designs. The individual parts of tapered roller bearings are commonly sold separately as cups and cones. Cones contain the roller assembly and inner ring while cups include the outer ring. Full assembly units contain both the cup and cone. As separable bearings, different designs and sizes are available to accommodate a variety of applications.

Wuxi Guangqiang Bearing Trade Co.,Ltd-Tel:86-510-82601571-Email:gq@gqbearing.com,shary@gqbearing.com-http://www.bearing-asia.com